

PROJECT SHOWING MINUTES

**North Lynn Street Esplanade Improvements**

Project No. 0029-000-859, C501, B605

UPC No. 109813

November 1, 2017 | 10:00 a.m. | 1911 North Ft. Myer Drive, LL-10, Arlington, VA

**Overview and Introduction: Mel Harvey, PE; Area Construction Engineer**

Mel Harvey opened the meeting and welcomed all in attendance. This was not a mandatory showing, but there would be a separate optional field visit. Self-introductions were made around the room.

Mr. Harvey then proceeded to go over the agenda that included:

- Project Overview
- Design features
- Construction Features
- Environmental
- Utility Features
- Civil Rights
- Project Controls / Contract & Schedule
- Questions and answers. He requested that anyone with a question first identify themselves and the company they represent before reciting their question.
- Optional Field visit

Mr. Harvey introduced the Project Team and speakers as follows:

VDOT Construction Management

Area Construction Engineer – Mel Harvey, PE

Construction Manager – Thomas Mulcahy, PE

Design Team:

VDOT Design Project Manager – Khalid Gandhi, PE

Engineer of Record – Toole Design Group, Bill Schultheiss, PE

Presenting Today:

Tom Hutchings – Arlington County DOT Capital Projects Manager

Eric Mongelli, PE – Toole Design Group

Charles Harvey, PE – VDOT ACE

Shea Ridings – VDOT Utilities Construction Program Manager

Behrooz Goudarzi, PE – VDOT Project Controls

**Presentation Details**

Please see attached presentation for specific details.

PROJECT SHOWING MINUTES

Project No. (NFO) 8102-029-065, P101, R201, C501, B628, B627, B629, D610

UPC No. 103907

---

**Question & Answer Session**

**Mel Harvey, PE – Area Construction Engineer**

Mr. Harvey asked for any questions from the contractor representatives and none were received.

**Conclusion**

- Upon adjournment of the showing:
  - Contractor was reminded to submit all questions thru the CABB system at [www.virginiadot.org](http://www.virginiadot.org) on the Advertisement page on the Construction and Maintenance website.
  - Questions and Answers and Project Showing Meeting minutes will be posted on VDOT's website [www.virginiadot.org](http://www.virginiadot.org). These will be located under Business Users / Proposals & Bidding / Project Ads.

The field visit was not performed due to lack of interest.

Attachment: Project Showing presentation  
Attendance Sheets



## **N. Lynn Street Esplanade Improvements**

### **PROJECT SHOWING**

Project No. 0029-000-859, C501, B605

November 1, 2017– 10:00 a.m.

**1911 North Fort Myer Drive, LL-10**

**Arlington, Virginia**

### **Charles Harvey, PE**

Area Construction Engineer, NOVA Construction

Charles.harvey@VDOT.Virginia.gov, Phone: (703) 259-3234

### **Thomas Mulcahy, P.E.**

Construction Manager, NOVA Construction

E-mail: Thomas.Mulcahy@VDOT.Virginia.gov, Phone: (703) 259-3350

## Showing Agenda

- **Project Overview**
- **Design Features**
- **Construction Features**
- **Environmental**
- **Utility Features**
- **Project Controls/Contract & Schedule**
- **Question and Answers**
  - Entertained at the end.
  - Attendees asking questions should identify themselves and the company they represent.

# Introduction of Project Team

## VDOT Construction Management

Area Construction Engineer – Charles Harvey, PE

Construction Manager – Thomas Mulcahy, PE VDOT

## Design Team:

VDOT Design Project Coordinator – Khalid Gandhi, PE

Toole Design Group – Designer Engineer of Record – Bill Schultheiss, PE

## Presenting Today:

Tom Hutchings – Arlington County DOT Capital Projects Manager

Eric Mongelli, PE – Toole Design Group

Charles Harvey, PE – VDOT ACE

Brady Redwine – VDOT Utilities Manager

Behrooz Goudarzi, PE – VDOT Project Controls

# Project Overview

Tom Hutchings

Arlington County Department of Transportation

Capital Projects Manager

# Project Location

- (A) Lynn Street Esplanade: North Lynn Street from eastbound Lee Highway to westbound Lee Highway
- (B) Custis Trail: westbound Lee Highway from N. Lynn Street to N. Oak Street.

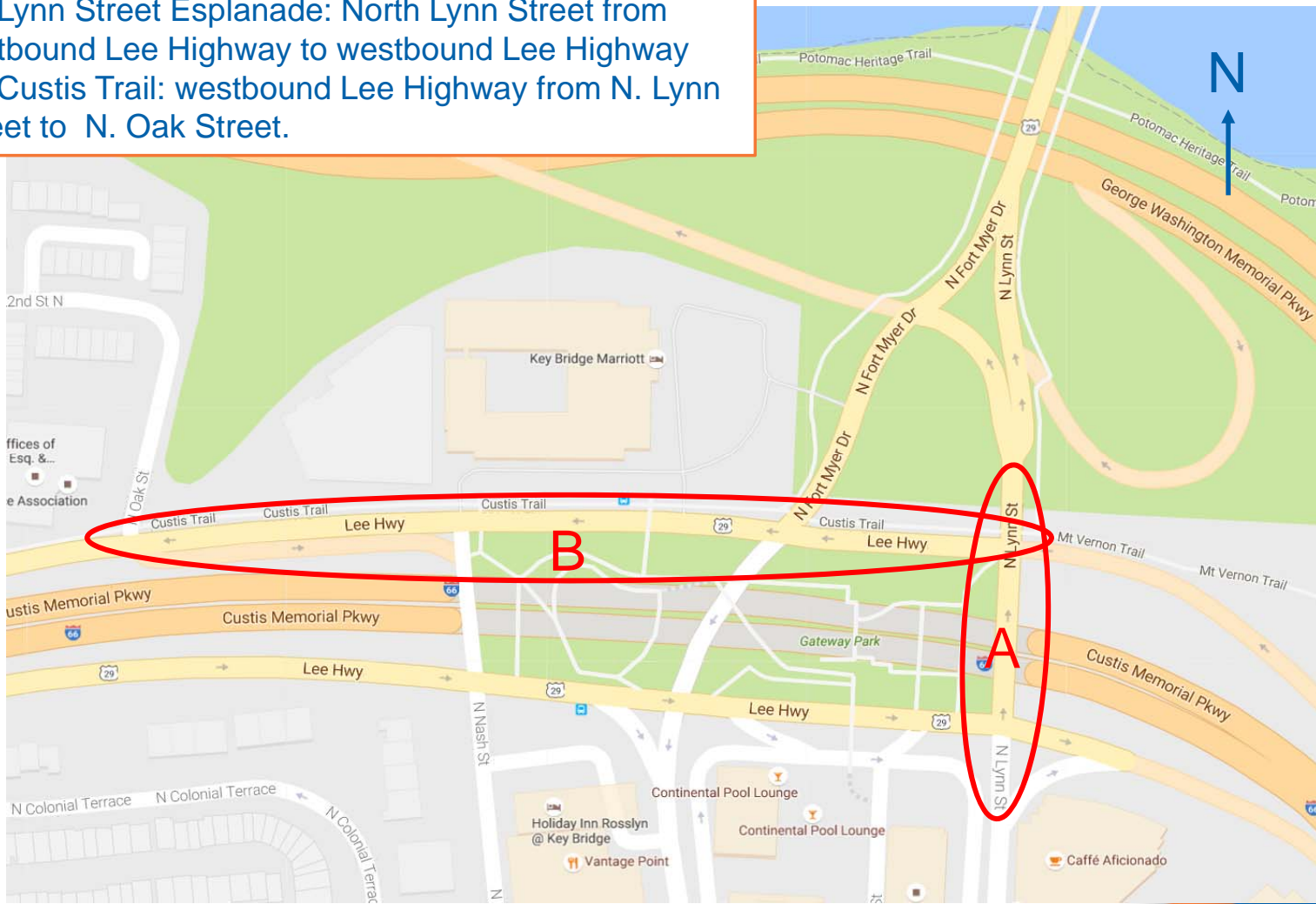

## Project Location

(A) Lynn Street Esplanade: North Lynn Street from eastbound Lee Highway to westbound Lee Highway  
(B) Custis Trail: westbound Lee Highway from N. Lynn Street to N. Oak Street.



- **The Lynn Street Esplanade and Custis Trail Improvements project is a pedestrian and bicycle safety, traffic management and street beautification initiative located in Rosslyn.**
- **The project incorporates findings from the 1999 Esplanade Study, the 2003 Rosslyn Circle Safety Study and the 2006 Lynn Street Esplanade Preliminary Design Study.**



## Project Location Street View:



(A) Lynn Street Esplanade: North Lynn Street from eastbound Lee Highway to westbound Lee Highway

## Project Location Street View:



(B) Custis Trail: westbound Lee Highway from N. Lynn Street to N. Oak Street.

# Design Features

Eric Mongelli, PE

Toole Design Group Director of Engineering

## The Lynn Street Esplanade (A)

- **Project includes:**

- Widened sidewalks and larger pedestrian and bike waiting areas
- 11' traffic lanes
- Upgraded traffic signals and new signage
- On-street bike lane on Lynn Street
- Upgraded street lights
- Custom fencing
- Landscaping
- “Corridor of Light” public art elements at the four corners of the I-66 bridge (By others)

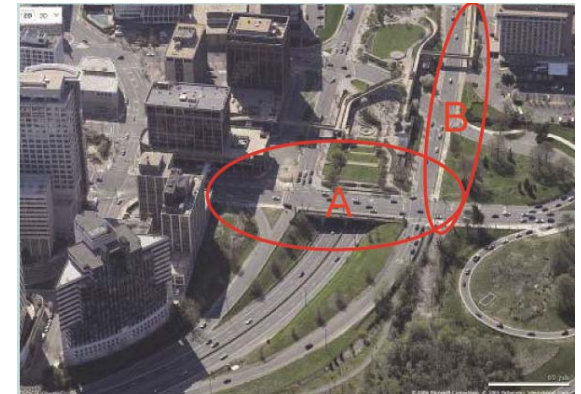

(A) Lynn Street Esplanade  
(B) Custis Trail

# N. Lynn Street Bridge Improvements (A)

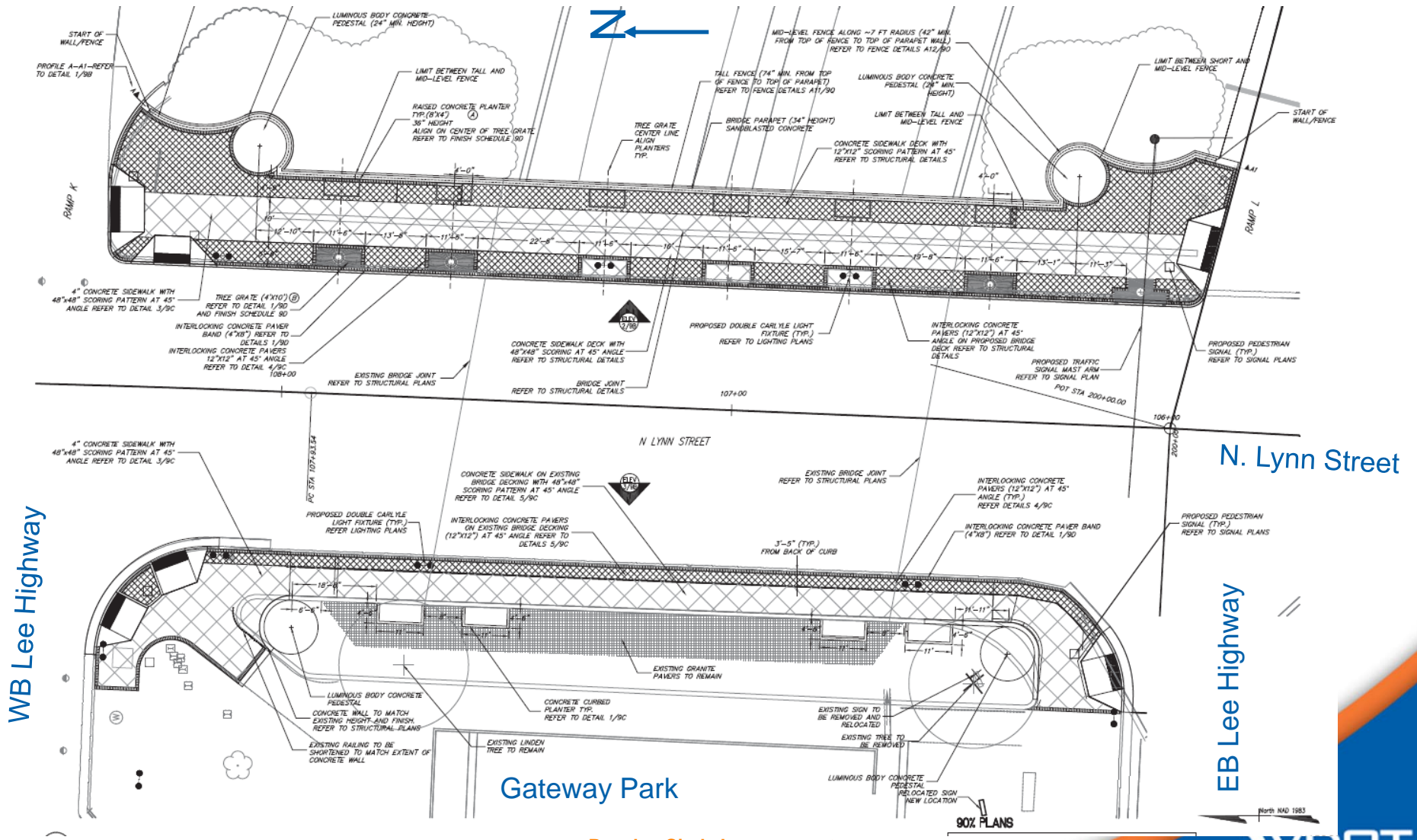

WB Lee Highway

EB Lee Highway

Rosslyn Circle Improvements



# East Side of Lynn Street Improvements (A)



Plan and elevation showing new bridge barrier, custom fence, 20' wide sidewalk

# East Side of Lynn Street Improvements (A)

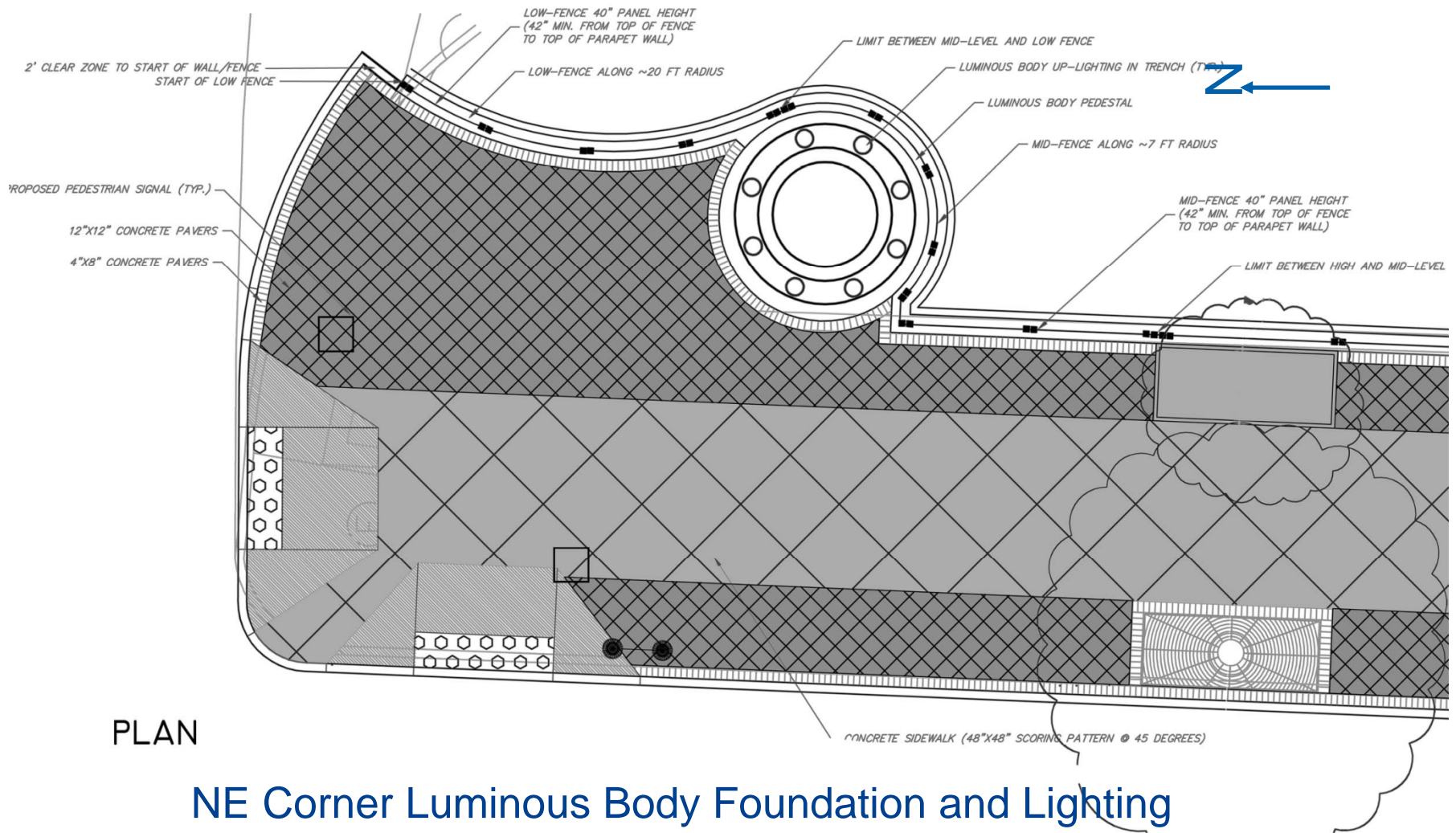

## NE Corner Luminous Body Foundation and Lighting

# West Side Lynn Street / Gateway Park (A)

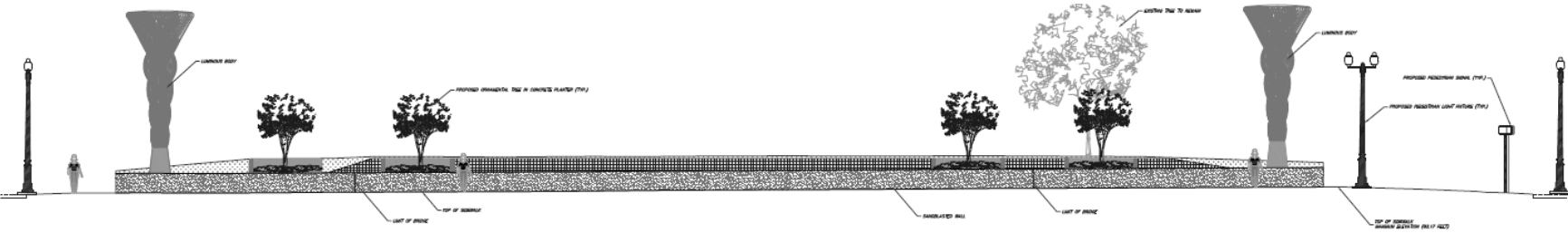
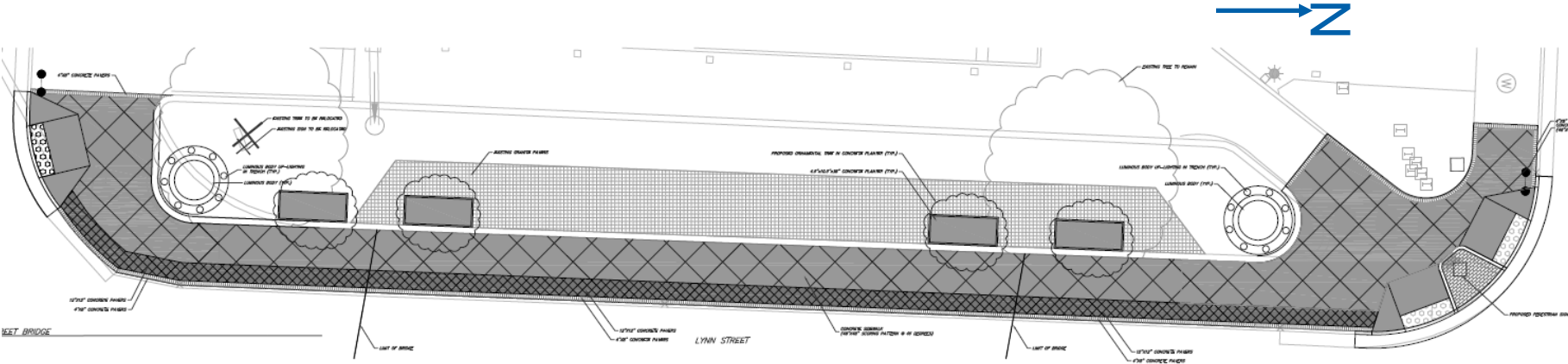

Plan and Elevation Graphics



# East Side Lynn Street

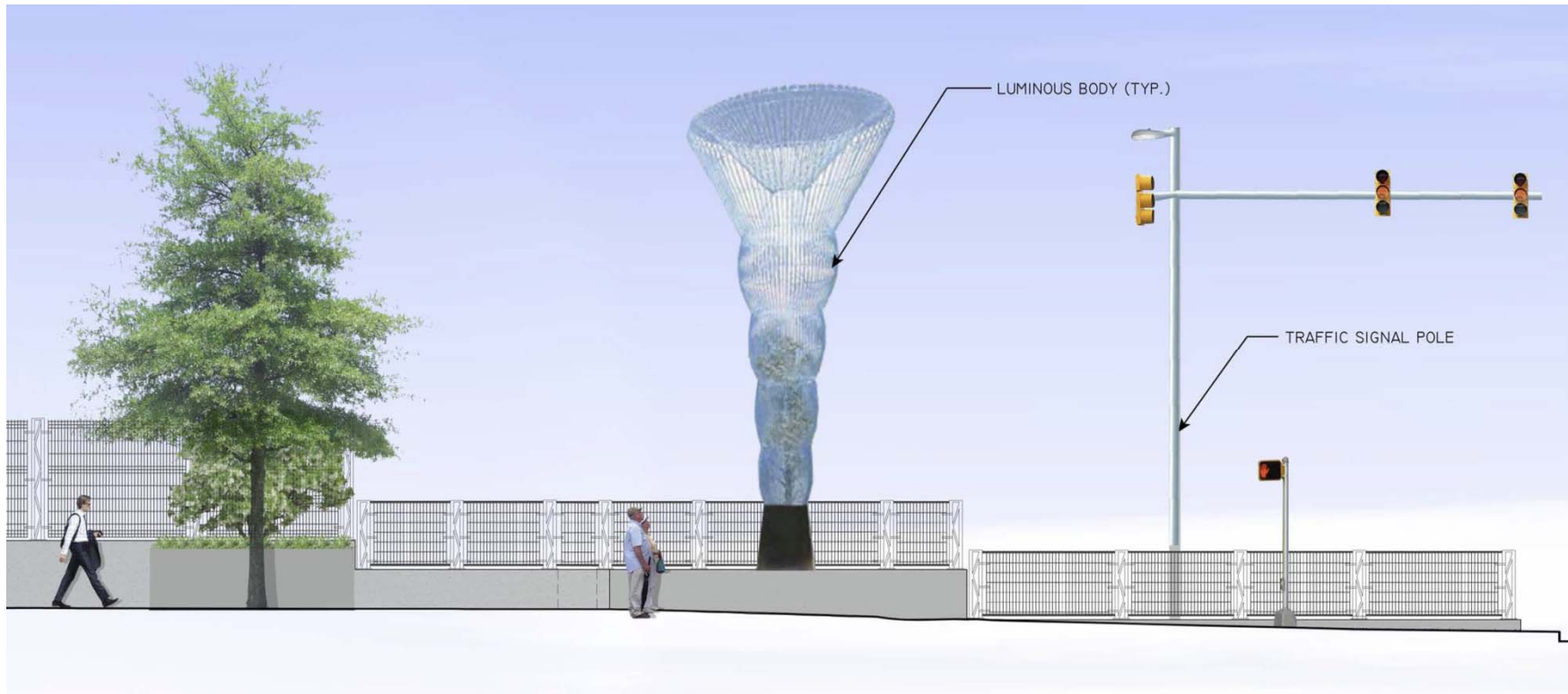

Southeast corner of Lynn and Lee Highway

Rosslyn Circle Improvements



# Public Art (Fixtures External to this Contract)



# Luminous Body Locations ●

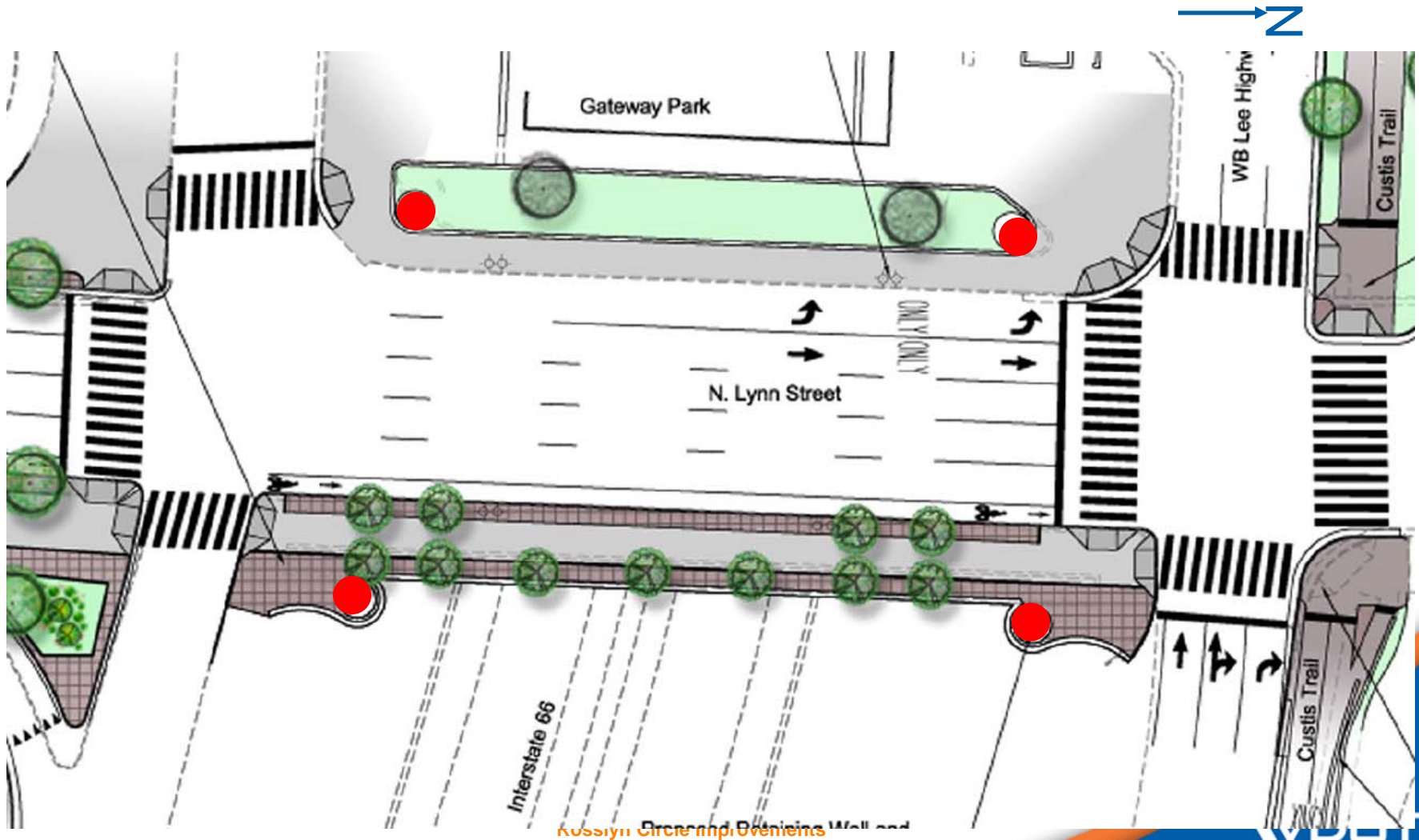

Kosslyn Circle Improvements



# Semi-Custom Fence

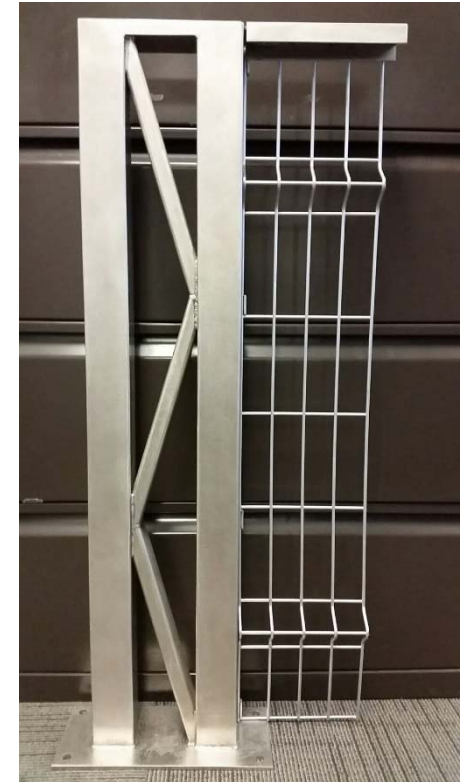
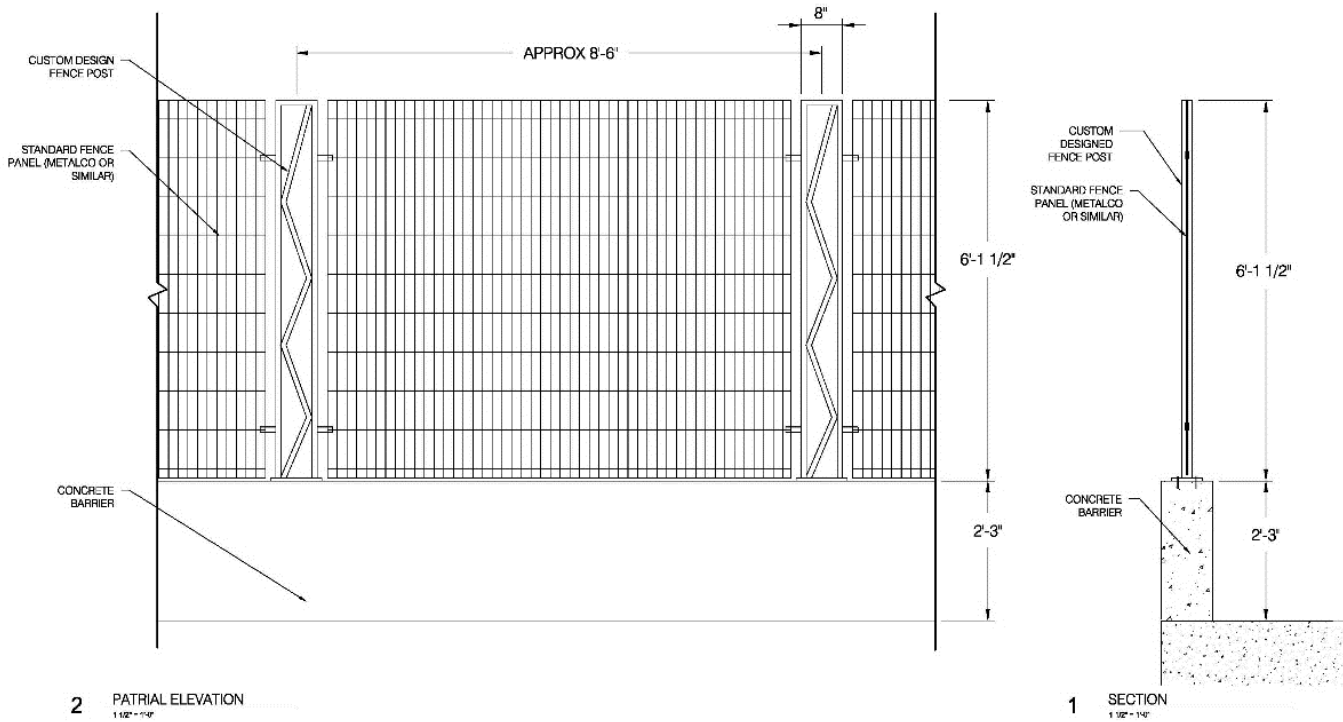

Full size mock-up

Cliff Garten Studio	131s Preston Way	project:	COL - ESPLANADE BRIDGE FENCE	project number:	sheet:
310.392.2000 TEL	Vanice	USA		date:	11/15/2012
310.392.2002 FAX	California	90291	ABOVE DECK	scale:	AS NOTED
					2.0

## Custis Trail Improvements (B)

- **Project area includes:**

- **Bicycle and pedestrian facility upgrades**
- **Intersection improvement at Lee Highway and N. Lynn Street**
- **Trail widening to 16'**
- **Increased trail separation from traffic**
- **Westbound lane reduction from Ft. Myer to N. Oak Street**
- **Curb extensions and wider curb ramps**
- **New traffic and dedicated bike signals**
- **New streetlights on both sides of westbound Lee Highway**



(A) Lynn Street Esplanade  
(B) Custis Trail

# Overview Custis Trail and Westbound Lee Highway Improvements (B)

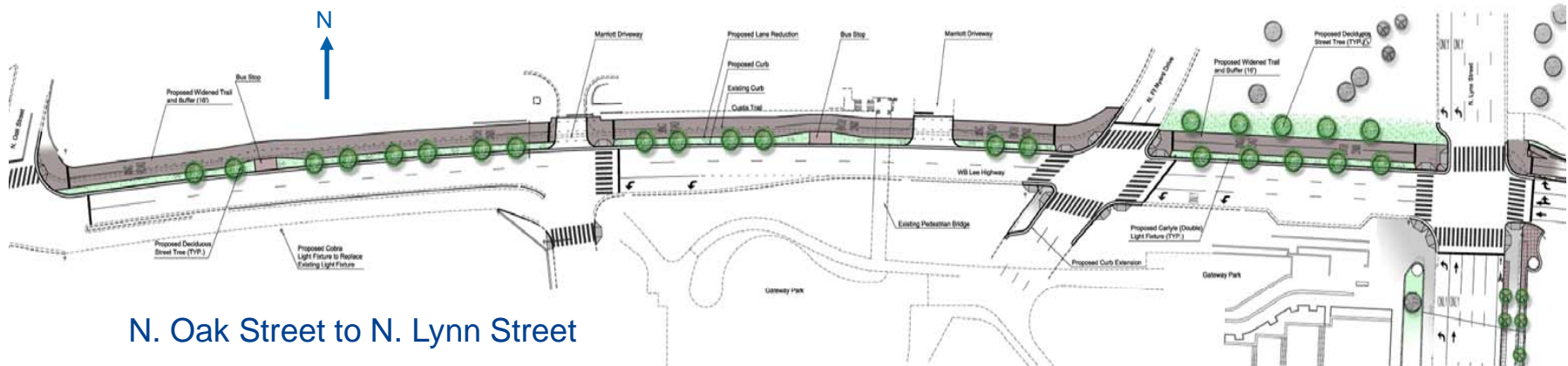

N. Oak Street to N. Lynn Street

- **Planned 16' wide trail with 6-foot buffer (existing 10' & 3' buffer)**
- **VDOT approved lane reduction on westbound Lee Highway provides space for wider trail and improved sight distances**
- **Improved pedestrian queuing areas at street crosswalks**
- **Upgraded traffic and trail signals at major intersections**

## Custis Trail at N. Lynn Street (B)

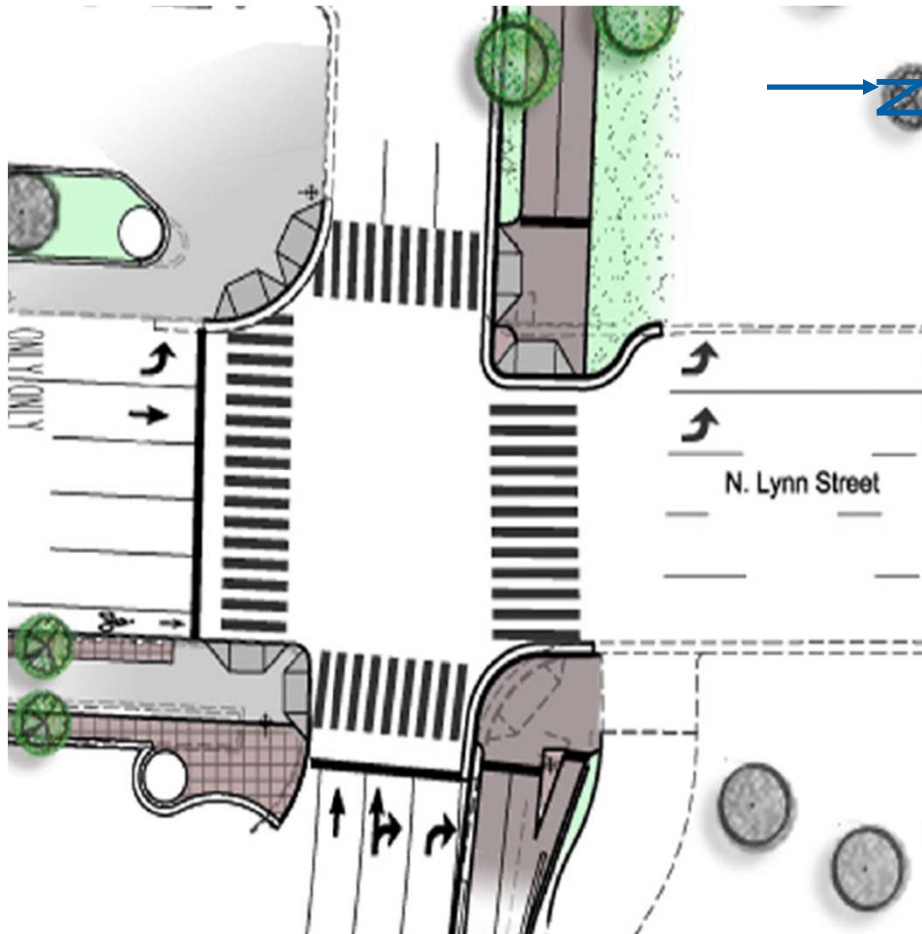

- Reduced crossing distances
- New traffic and trail signals
- Larger trail queuing areas
- Barrier removed for Improved visibility of trail users
- Tighter corners to slow traffic in pedestrian areas

## Custis Trail at Fort Myers Drive (B)

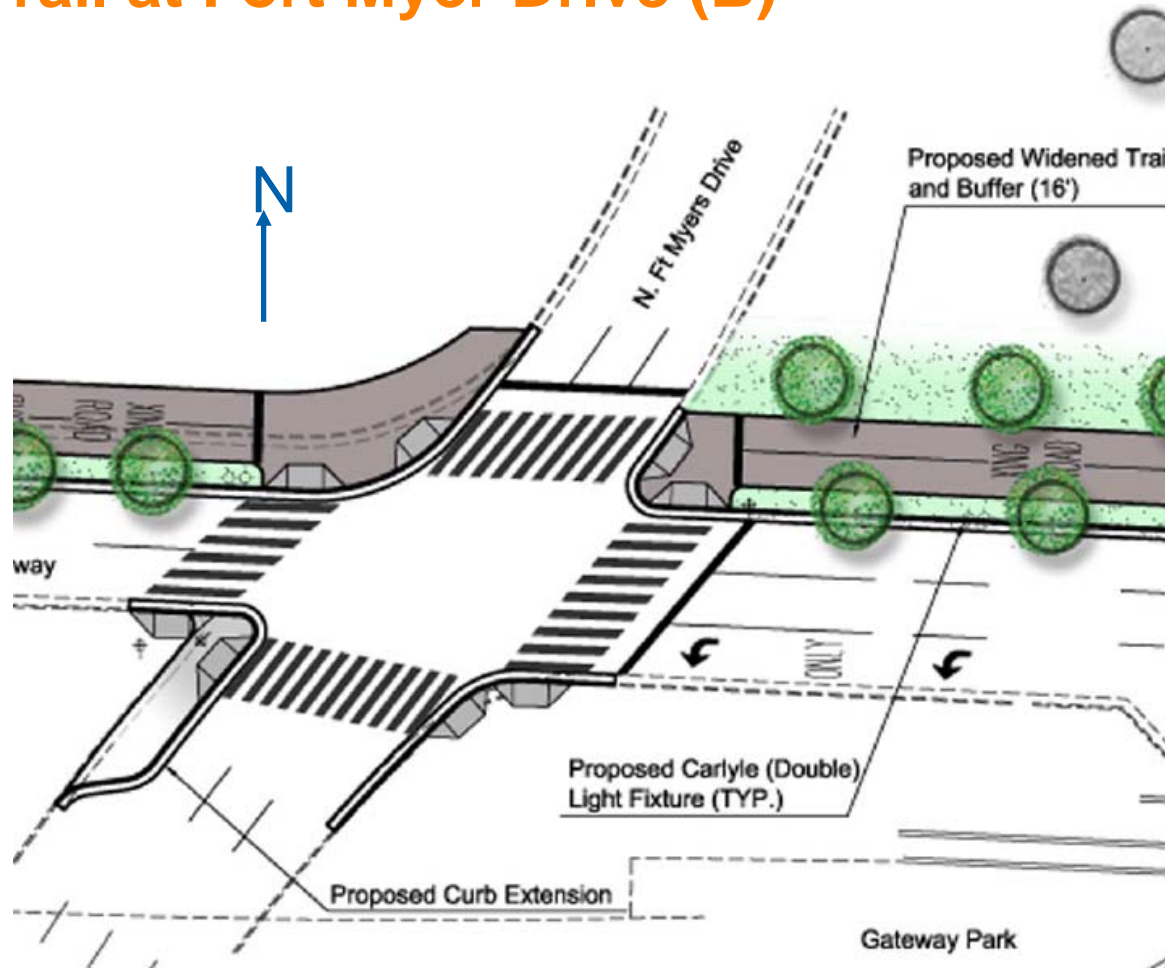

Dashed lines show existing curb location



## Custis Trail at Marriot Entrance (B)

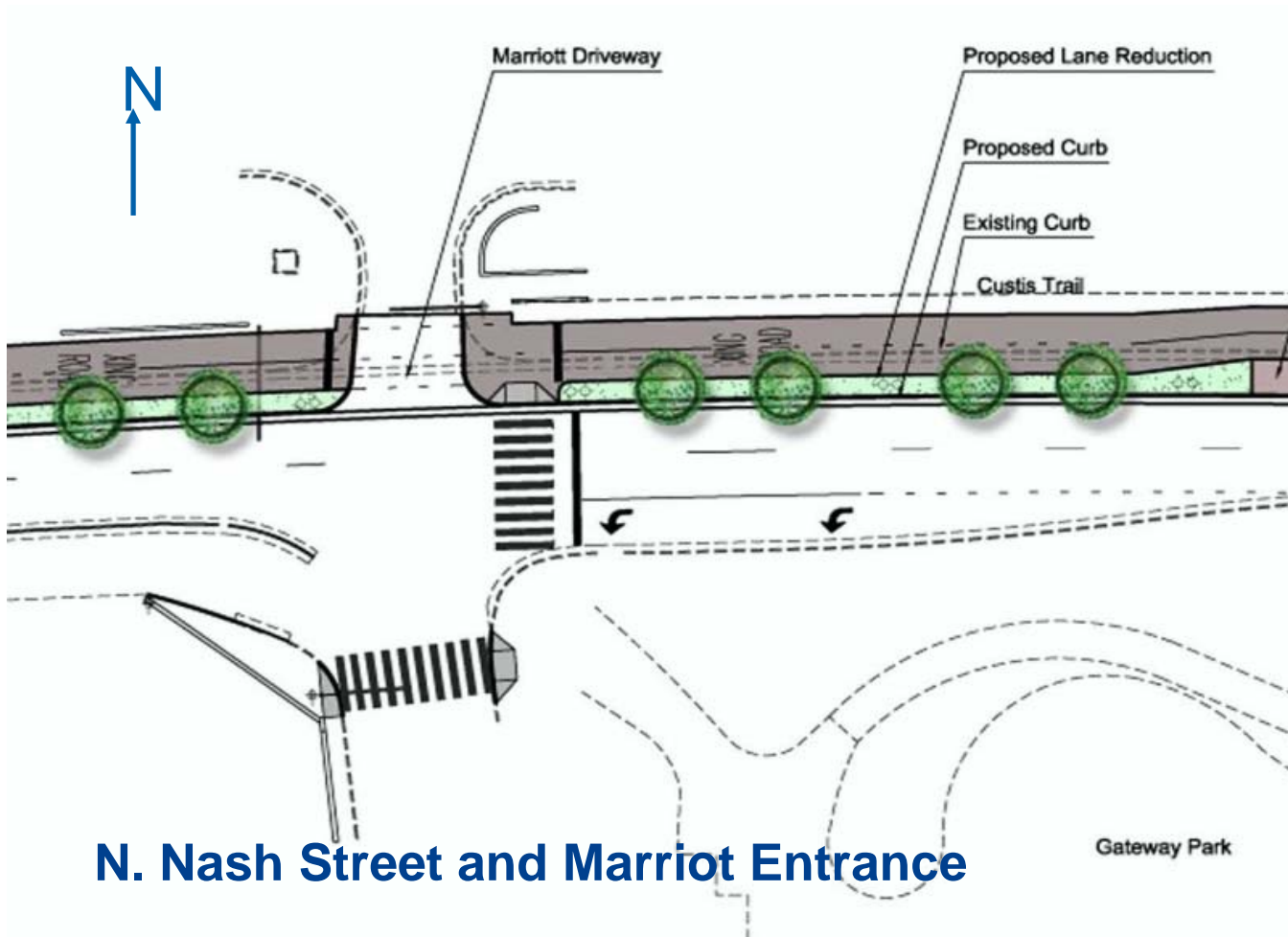

**N. Nash Street and Marriot Entrance**

# Existing Custis Trail N. Fort Myer Drive to N. Oak Street (B)



Existing Conditions – N. Ft Myer Drive to N. Oak Street

# Approved Lane Reduction N. Fort Myer Drive to N. Oak Street (B)



# Construction Features

Charles Harvey, PE

VDOT Area Construction Engineer

## Construction Safety

- **Six (6) Phases with Nine (9) MOT Plans**
- **Safety**
  - Uphold all applicable standards and regulations
  - Maintain pedestrian and bicycle access throughout
  - Maintain a safe and clean job site

## Construction Public Outreach

- **Be a Good Neighbor**
  - Will work very closely with Arlington County
  - Must have a Preconstruction Meeting with Waterview Property and Marriott Property prior to mobilizing to the site.
  - Notify Arlington County Transit no less than two weeks prior to starting any work that would impact existing bus service stops
  - Pardon our Dust Meetings
  - VDOT Public Relations Team

## Construction Process

- **Communication**
  - Open lines at all times
  - Partnering
- **Submittals – Timely and diligent**
- **Documentation – Complete and timely for pay estimates**
- **Signals – Temporary and permanent signalization**
- **Demolition**
- **Field Office Type III**

# Environmental

Charles Harvey, PE  
VDOT Area Construction Engineer



# Erosion and Sediment Control

- **Contractor Implemented**
  - **VDOT Monitored**
  - **Approved ESC Plan**
    - VDOT Road & Bridge Specifications and Standards pertaining to regulated land disturbing activities
    - DCR Virginia Erosion and Sediment Control Handbook
- **VDOT ESCCC and DCR Inspector Certification**
- **Construction Entrances (Std. and Spec. 3.02)**

# Disposal Areas

- **Section 106.04 Virginia Road & Bridge Specifications and Standards**
- **Disposal Site Approval**
  - Location and boundaries
  - Procedures to minimize erosion
  - Haul roads
  - Provisions for environmentally compatible screening
  - Restoration and permanent cover vegetation
  - Drainage pattern
  - Stream/tributaries receiving discharge
  - Sequence and schedule of work
  - Total drainage area for temporary sediment traps

# Utility Features

Brady Redwine  
VDOT NOVA Construction  
Utilities Manager

# Status of Utility Relocation

Name of Utility	Status	Projected Completion Date
Dominion VA Power (DVP)	Complete	
Washington Gas	Complete	
PEPCO	In progress	November 2017

## Important Special Provisions and Coordination

- **Section 105.08 – The Contractor shall protect existing, adjusted, or new utilities that are shown on the plans, marked by Miss Utility, or otherwise known to the Contractor that are to remain within the right of way so as to prevent disturbance or damage resulting from construction operations.**
- **Section 107.09 - The Contractor shall comply with all requirements of the Virginia Underground Utility Damage Prevention Act (the Miss Utility law). The Contractor shall not make or begin any excavation or demolition without first notifying the Miss Utility notification center for the area where the project is located.**

## Important Special Provisions and Coordination (cont.)

- **The Contractor shall promptly notify the Engineer in writing if the Contractor encounters utilities that are not shown on the plans, marked by Miss Utility, or otherwise known to the Contractor before the site is disturbed further and before the affected work is performed.**
- **Any coordination with Power and/or Communications for utility services to traffic signals, overhead lighting, etc... requires a 90 day notice.**
- **The Department will provide a Utility As-Built plan to the successful bidder at the Pre-Construction Conference. This plan will show all of the new locations for the relocated utilities within the project limits.**

# Project Controls

Behrooz Goudarzi, PE

VDOT Project Controls Section

## Contractual Project Dates

- **Substantial Completion Date of March 23, 2020**
  - Incentive of \$4,000 per day up to \$240,000
  - Disincentive of \$4,000 per day
- **Fixed Completion Date of April 30, 2020**
- **Must notify VDOT in writing of intention to collect incentive with the submission of the Baseline Schedule**



# Special Provisions

## CPM Progress Schedule for Category III Projects

- Preliminary Progress Schedule
  - Within two (2) days prior to the Scheduling Conference
  - Submit: 90 day CPM Schedule and Narrative
- Baseline Progress Schedule
  - Within thirty (30) days after NTP
  - Submit: Cost loaded CPM Schedule, Narrative and Earnings C-13C
  - Becomes Schedule of Record
- Monthly Progress Update
  - Within five (5) business days after the progress estimate date
  - Submit: CPM Schedule Update, Narrative and Earnings C-13C
- **Software: No earlier than Primavera P6 Version 6.2**
- **Other features**
  - Revised Baseline Schedule
  - Schedule Impact Analysis (SIA)

# The Team

- **Informal Partnering**
  - **Special Provision included to include Kick-off Meeting and additional facilitated meetings, etc.**

# Questions & Answers

- Bid Letting is Wednesday - December 20, 2017
- Attendees asking questions should identify themselves and the company they represent.
- Any additional questions that may arise after this project showing shall be addressed through the normal CABB process.

## Field Visit Location

- Meet on sidewalk at SW corner of eastbound Lee Highway and N. Lynn Street (down one block)

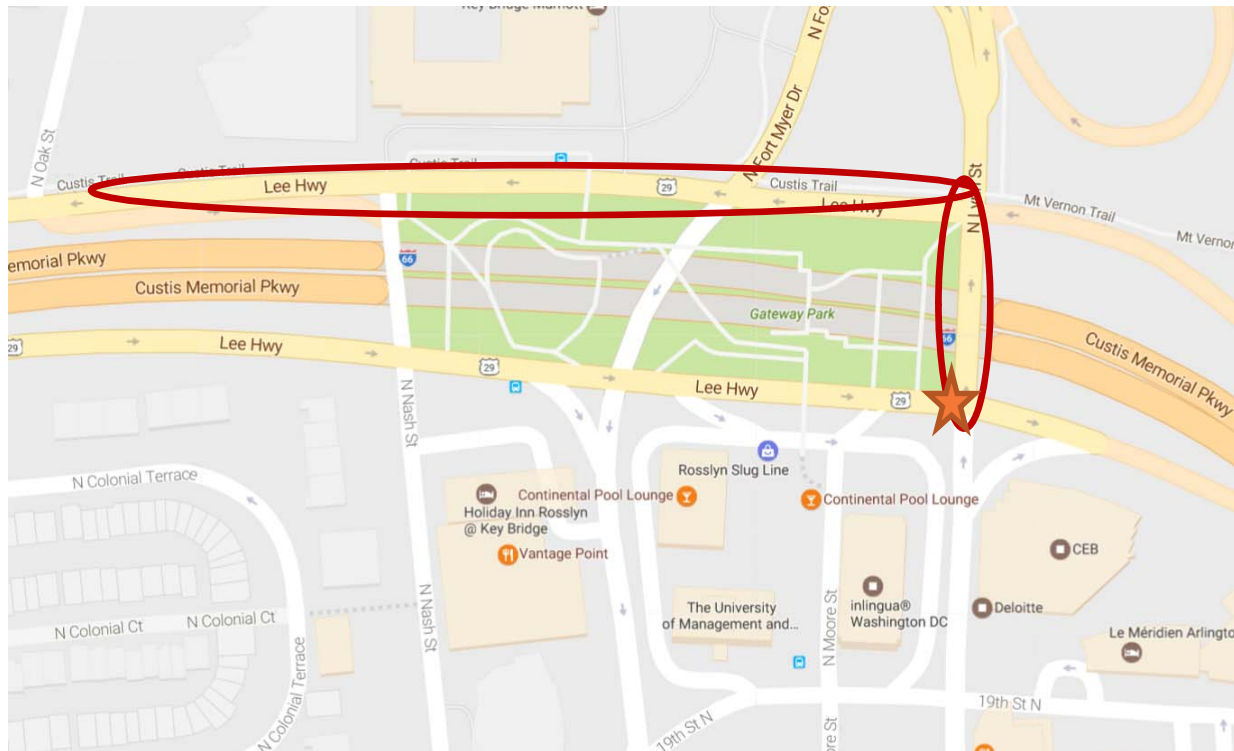

COMMONWEALTH OF VIRGINIA  
DEPARTMENT OF TRANSPORTATION

PROJECT SHOWING ATTENDANCE SHEET

CONTRACT ID. NO.: C0000109813C01 PROJ. NO.: (NFO)0029-000-859, C501, B605 Area Construction Engineer Charles Harvey, PE  
 ROUTE: 29 COUNTY: Arlington DATE: November 1, 2017  
 DISTRICT: NOVA District ROOM: On Site, Rosslyn Virginia TIME: 9:30 a.m.

REPRESENTATIVE	COMPANY	E-Mail Address	PHONE NUMBER	SHOWING (INITIALS)
Tom Hitchings	ARLINGTON COUNTY	THITCHINGS@ARLINGTONVA.US	703 582-2523	TH
Melvin Harvick	NOVA CONST	Charles.Harvick	703 259 3234	CH
Liz Gilliam	Tool Design Group	egilliam@tooledesign.com	301 927 1900	EG
ERIC MONSELLI	TOOL DESIGN GROUP	EMONSELLI@TOOLEDSIGN.COM	301 927 1900	EM
Adil Chauhan	Arlington County	achauhan@arlingtonva.us	(703) 228-3540	AC
KHALID GANDHI	VDOT - L&D	KHALID.GANDHI@VDOT.VIRGINIA.GOV	703/259-2397	KG
Pelou Sevet	VDOT - Proj Control	Pelou.Sevet@VDOT.VIRGINIA.GOV		PS
Victor Corcano	Rosslyn BID	VCORCANO@ROSSLYNVA.ORG	301 254 71220	VC
BRIAN GROVER	A&M CONCRETE L&P	bgrover@amconcrete.net	703-544-0850	BG
Fares ALSABE	Fort Myer cons.	bids@fortmyer.com	202-636-9535	FA
Michael Maisel	VDOT	michael.maisel@vdot.virginia.gov	571-330-8174	MLM
SHEA RIDINGS	VDOT- UTILITY CONST.	SHEA.RIDINGS@VDOT.VIRGINIA.GOV	703-259-1787	SR
ARAS MOHAMMED	VDOT- Project Control	Aras.Mohammed@VDOT.V.	703-259-1797	AM
Royce Sims	Shirley Contracting	charles.sims@shirleycontracting.com	703 380 3823	RS
Jose A Bravo	Anchor Const.	jbravo@anchorconst.com	(202) 437-4569	JB
TOM MULCAHY	VDOT- CONSTRUCT.	THOMAS.MULCAHY@VDOT.VIRGINIA.GOV	(703) 259-3350	TM

